

PROPOSED BOUNDARIES OF
COUNTY OF MADERA
COMMUNITY FACILITIES DISTRICT NO. 2022-1
(GUNNER RANCH)
COUNTY OF MADERA
STATE OF CALIFORNIA

Assessor Parcels within
Improvement Area No. 1 of
County of Madera C.F.D. No.
2022-1 (Gunner Ranch):

- 049-082-012
- 049-082-013
- 049-084-001
- 049-084-002
- 049-087-001
- 049-087-002
- 049-087-003
- 049-087-004
- 049-087-005
- 049-087-006
- 049-087-007
- 049-087-008
- 049-087-009
- 049-087-010
- 049-087-011
- 049-087-012
- 049-087-013
- 049-087-014
- 049-087-015
- 049-087-016

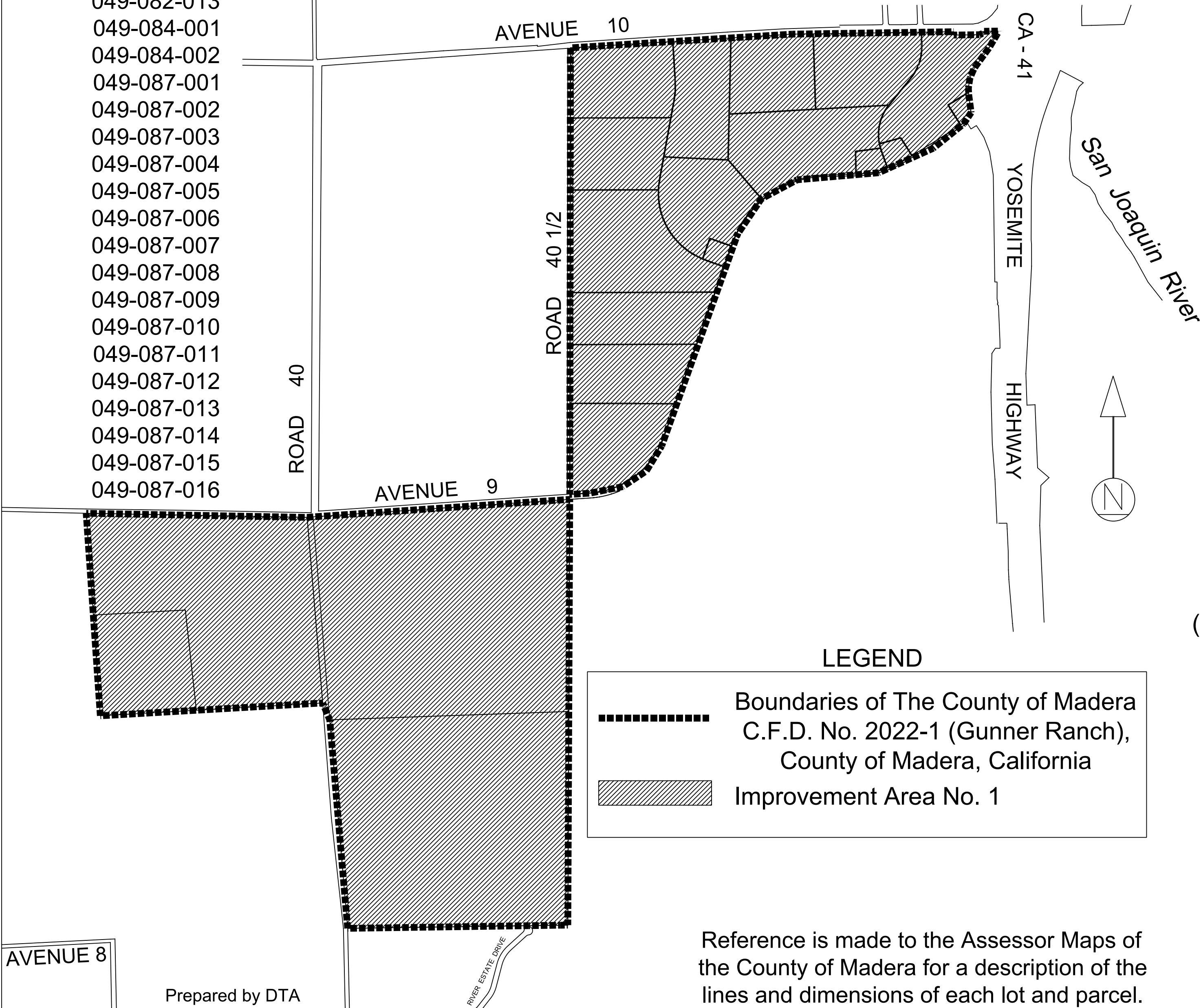

(1) Filed in the office of the Clerk of the Board of Supervisors of the County of Madera this ____ day of _____, 2022.

Clerk of the Board, County of Madera

(2) I hereby certify that the within map showing the proposed boundaries of the County of Madera Community Facilities District No. 2022-1 (Gunner Ranch), Madera County, State of California, was approved by the Board of Supervisors of the County of Madera at a regular meeting thereof, held on the ____ day of _____, 2022, by its Resolution No. _____.

Clerk of the Board, County of Madera

(3) Filed this ____ day of _____, 2022, at the hour of ____ o'clock __m, in Book _____ of Maps of Assessment and Community Facilities Districts at page _____ and as Instrument No. _____ in the office of the County Recorder of Madera County, State of California.

Rebecca Martinez, County Clerk-Recorder & Registrar of Voters, County of Madera

By _____ Deputy

Fee _____

Reference is made to the Assessor Maps of the County of Madera for a description of the lines and dimensions of each lot and parcel.

PROPOSED BOUNDARIES OF
COUNTY OF MADERA
COMMUNITY FACILITIES DISTRICT NO. 2022-1
(GUNNER RANCH)
COUNTY OF MADERA
STATE OF CALIFORNIA

Reference is made to
the Assessor Maps of
the County of Madera
for a description of the
lines and dimensions of
each lot and parcel.

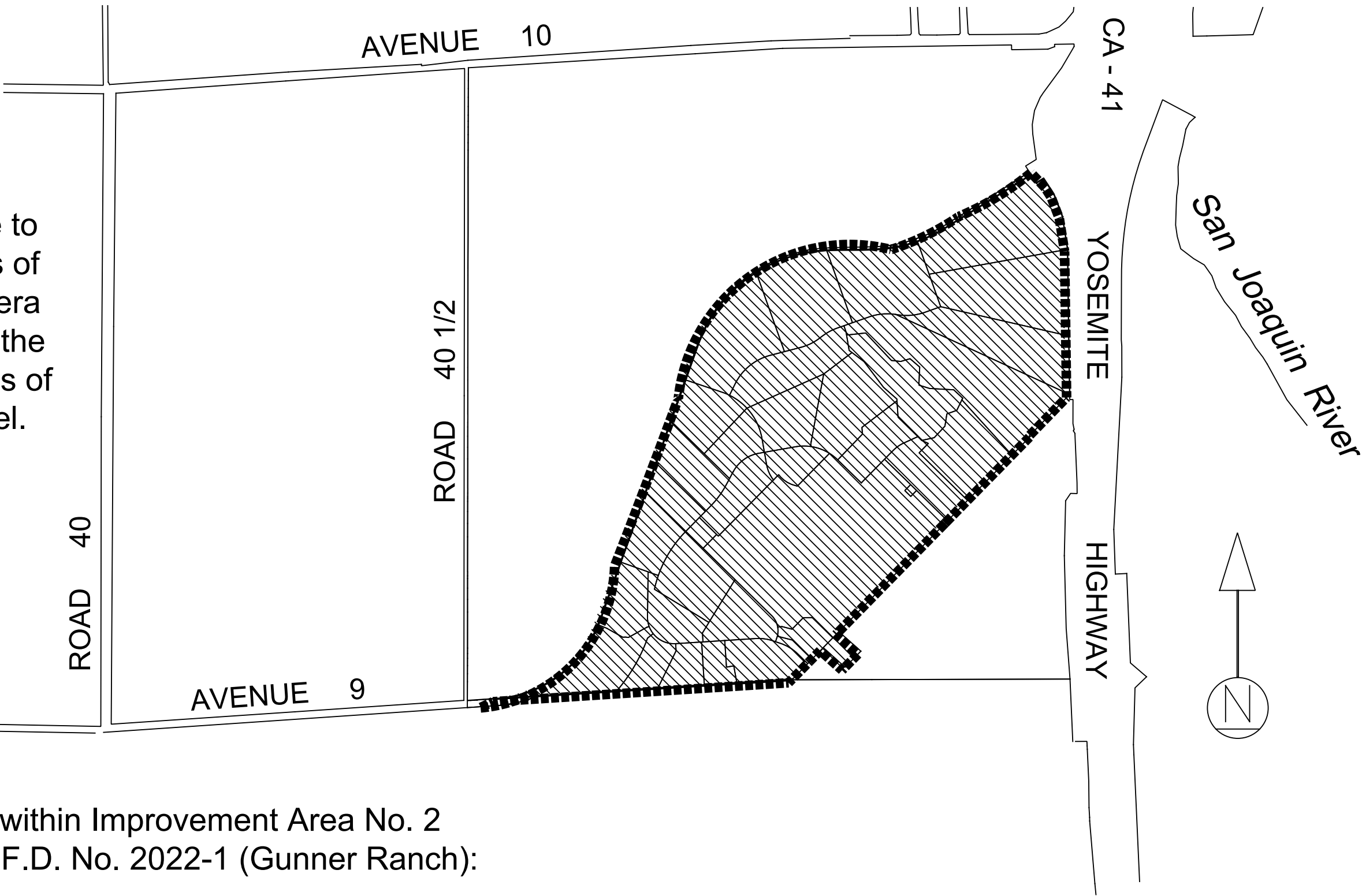

Assessor Parcels within Improvement Area No. 2
County of Madera C.F.D. No. 2022-1 (Gunner Ranch):

049-085-007	049-680-005	049-680-017
049-086-003	049-680-006	049-680-018
049-086-004	049-680-007	049-680-019
049-086-011	049-680-008	049-680-020
049-086-012	049-680-009	049-680-021
049-086-014	049-680-010	049-680-022
049-086-021	049-680-011	049-680-023
049-086-022	049-680-012	049-680-024
049-680-001	049-680-013	049-680-025
049-680-002	049-680-014	049-680-026
049-680-003	049-680-015	049-680-027
049-680-004	049-680-016	049-680-028

LEGEND

-----	Boundaries of The County of Madera
-----	C.F.D. No. 2022-1 (Gunner Ranch),
	County of Madera, California
////	Improvement Area No. 2

(1) Filed in the office of the Clerk of the Board of
Supervisors of the County of Madera this ____
day of _____, 2022.

Clerk of the Board, County of Madera

(2) I hereby certify that the within map showing the
proposed boundaries of the County of Madera
Community Facilities District No. 2022-1
(Gunner Ranch), Madera County, State of
California, was approved by the Board of
Supervisors of the County of Madera at a
regular meeting thereof, held on the ____ day
of _____, 2022, by its Resolution No.
_____.

Clerk of the Board, County of Madera

(3) Filed this ____ day of _____, 2022, at the hour
of ____ o'clock __m, in Book _____ of Maps of
Assessment and Community Facilities Districts at page
_____ and as Instrument No. _____
in the office of the County Recorder of Madera County,
State of California.

Rebecca Martinez, County Clerk-Recorder & Registrar
of Voters, County of Madera

By _____
Deputy

Fee _____